

15 Leslie House

2 Bed Ground Floor Apartment

108m² / 1162ft²

Kitchen / Dining / Lounge : 6.60 x 6.18m

Utility : 1.50 x 1.70m

Bedroom 1 : 3.51 x 4.43m

En-Suite : 1.40 x 2.57m

Bedroom 2 : 2.90 x 3.56m

Bathroom : 2.98 x 1.70m

All dimensions / areas are approximate and subject to change due to normal building tolerances
 Leslie House Dev Co Ltd reserve the right to make amendments to the design and specification as the development progresses and the drawings are updated

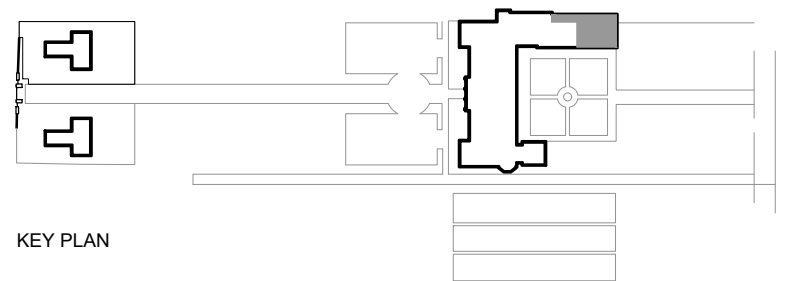

ELECTRICS LEGEND :-

- Double 13 Amp socket at low level
- Double 13 Amp socket at high level
- One Way Light Switch
- Two Way Light Switch
- Pendant Light Fitting
- Telephone Point
- CAT 5 Data Point
- T.V. Aerial Point
- Mechanical Extract Fan
- Central Heating Programmer
- Elec. Distribution Board
- Switched Fused Spur
- Ccu
- 5A 5 Amp Lamp socket
- Heated Towel Rail spur
- Single Socket at low level For Adjacent Appliance
- Door Bell
- Outside Light
- HD Heat Detector
- SD Smoke Detector
- SS Shaver Socket
- Trickle Ventilation
- LED (Specification TBC) IP Rated where appropriate.
- LED (Specification TBC) IP Rated where appropriate.
- LED Walk Over Floor Light (Spec TBC)
- Mirror with Integral Lighting
- Wall Light
- Duel Fuel Towel Rail with Fused Spur
- Entry Phone Panel